

# FLIGHT OF THE BUTTERFLY

THE TOTAL REPURPOSING OF THE BUTTERFLY HOUSE VIA A CIRCULAR LIFESTYLE

Laurie Chetwood, Chairman of Chetwoods, is developing the first UK architectural project which displays a 'Circular Lifestyle'.

The ground-breaking scheme's philosophy encapsulates three elements from a circular economy viewpoint: social, ecological and material. This new approach translates into what is called a 'Circular Lifestyle', which is unique as it not only considers the building's materials as part of the circularity process, but also people and ecology.

The Butterfly House in Surrey is being repurposed into a scheme which is a multi-functional, not for profit facility for people to visit, rejuvenate, recharge and more.

The project has sustainability at its heart and is also utilising cutting-edge technology to record and analyse human emotional response to design.

*THE FIRST UK ARCHITECTURAL PROJECT WHICH INHABITS A 'CIRCULAR LIFESTYLE'*

## ABOUT LAURIE CHETWOOD

Laurie Chetwood is an innovative artist and architect with colourful ideas and a radical vision.

He believes that by unleashing the unexpected and pushing what's possible, true advances can be made. His creative vision lies at the heart of Chetwoods Architects and underpins the design philosophy of the practice.

**SIGN UP TO RECEIVE THE LATEST UPDATES ON THE PROJECT** >

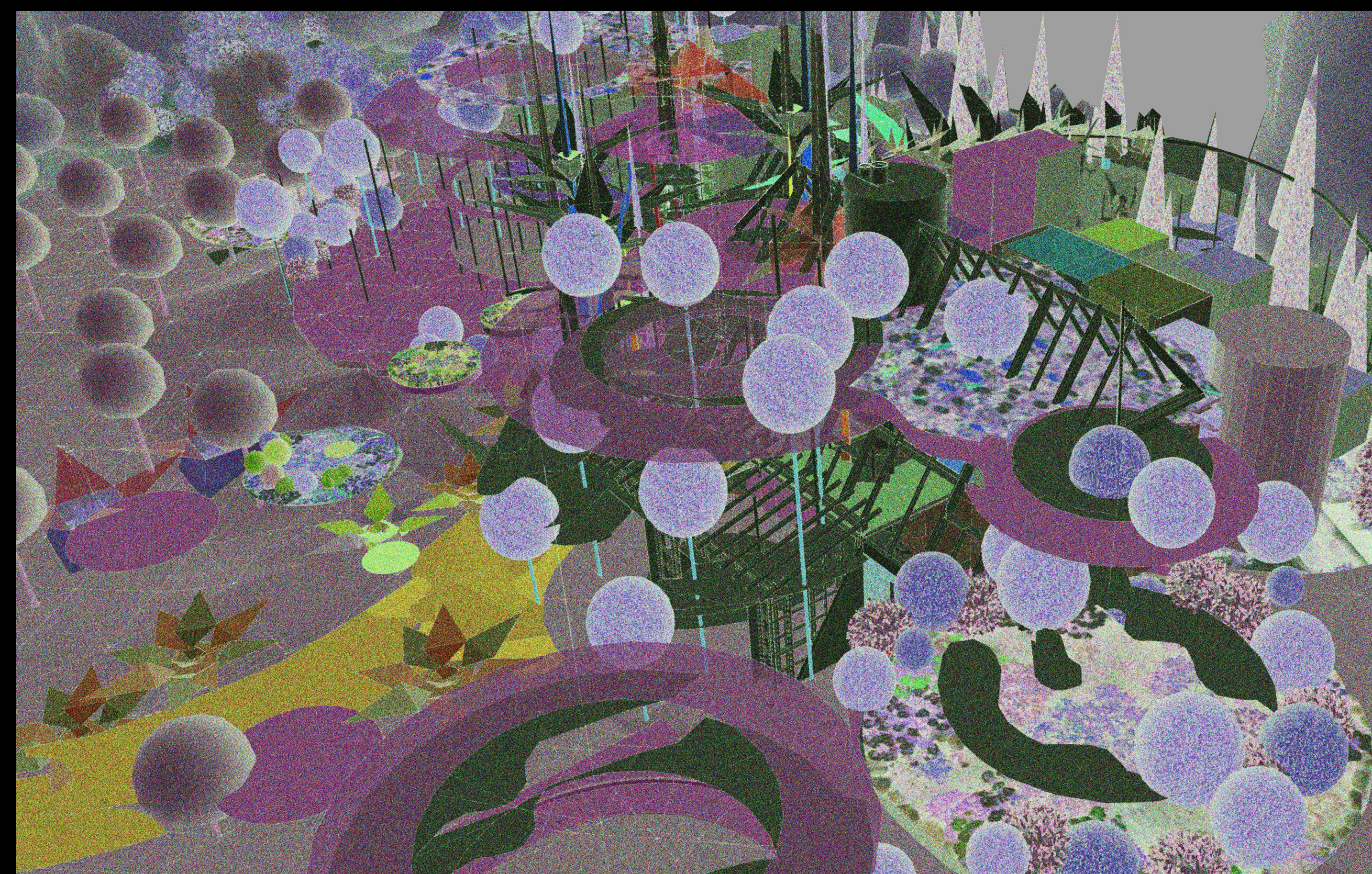
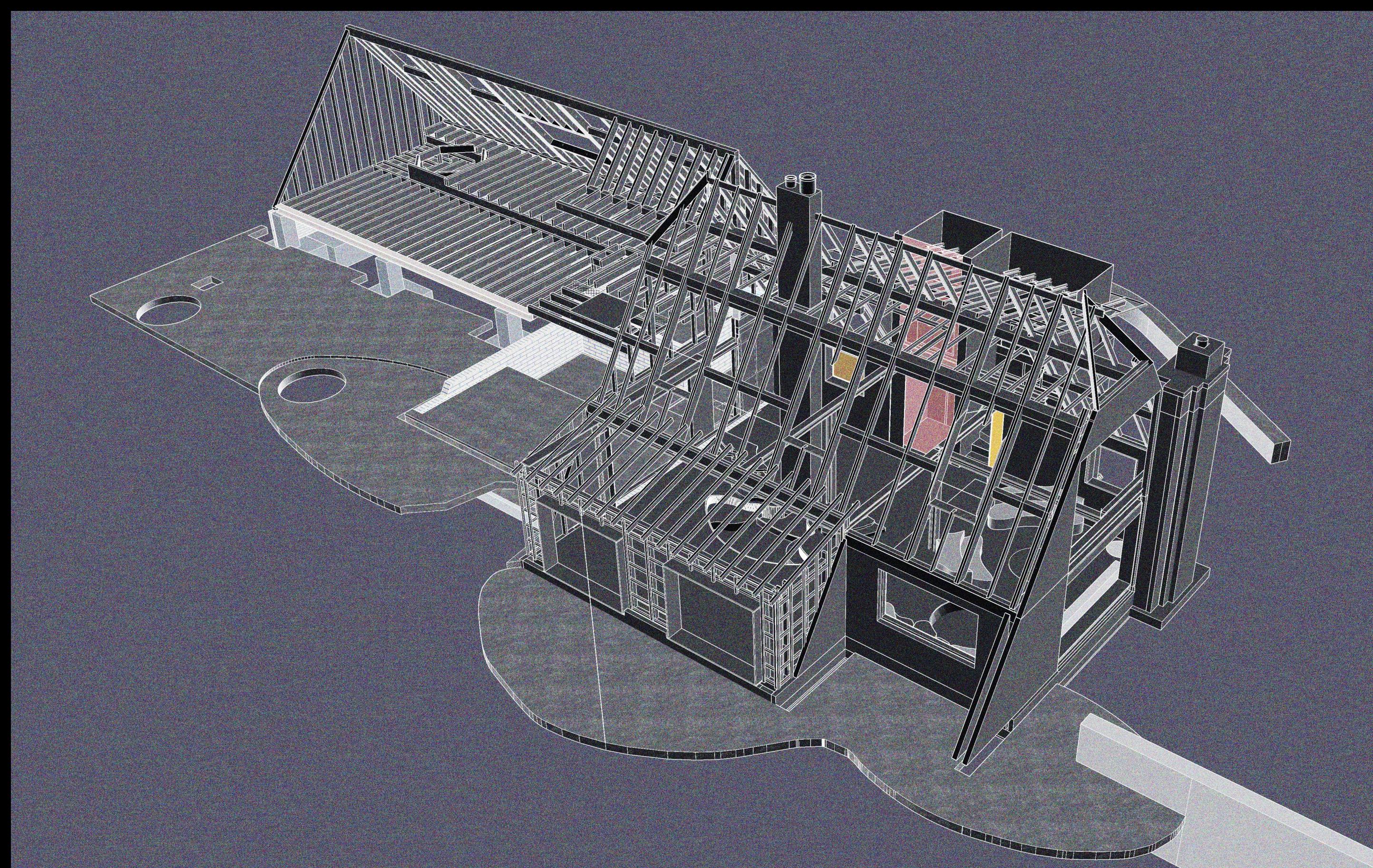

Our team have been utilising Scan2BIM 3D laser scanning technology to capture the existing building's physical characteristics in the form of Point Cloud data. This was converted into Revit BIM to develop a detailed, accurate and realistic interactive model of the existing building on the site.

